



FLEXIGLASS FITTING MANUAL - SECTION 1.2G

HOLDEN COLORADO FLEXISPORT CANOPY FIT - ISSA3

Note: Familiarise yourself with the instructions before you start to ensure you are clear on all aspects of the fit

SAFETY EQUIPMENT

- Hearing protection as required
- Eye protection as required

TOOLS REQUIRED

- Plywood or cardboard sheet
- Pneumatic or hand hacksaw
- Grinder, sander or file
- Metal priming paint
- Paint brush
- Silicone sealant & applicator
- Pneumatic or electric drill
- 5mm Drill bit
- Rivet gun with 5mm capacity
- 6mm Allen key
- 17mm Socket
- Pneumatic or hand driver
- 0-25Nm torque wrench
- Cable cutter, stripper, crimp tool
- Lock tight
- Knife or scissors
- Snake for guiding cables
- IPA Wipes or similar cleaning product
- Toledo cable strippers
- Würth Cable strippers

MATERIALS & PARTS REQUIRED

Part No.	Description	Qty.
PLT310	Plate RA Rodeo Cover In Sets	1 Pr.
SCRHHSS825	Screw Set S/S 304 Hexagon Head 8 x 25mm	4
WSH220	Washer 5/16 X 3/4 Flat	8
GRO10	Grommet Champ 3/16x5/16x7/16	1
CON130	Connector Wire 3-4mm WH Narva	1
Plus the same parts as per normal canopy fit.		

LIST OF COLORADO FLEXISPORT CANOPY COLOURS AVAILABLE

CANFSCODAW	Canopy FS Col DC Alpine White	Colour Code 877
CANFSCODBS	Canopy FS Col DC Black Sapphire	Colour Code 685
CANFSCODIB	Canopy FS Col DC Imperl Blonde	Colour Code 688
CANFSCODIPB	Canopy FS Col DC Impulse Blue	Colour Code 06U
CANFSCODMO	Canopy FS Col DC Misty Onyx	Colour code 518
CANFSCODPR	Canopy FS Col DC Primed	
CANFSCODRG	Canopy FS Col DC Royal Grey	Colour Code 90U
CANFSCODSS	Canopy FS Col DC Sterling Silv	Colour Code 49U
CANFSCODTR	Canopy FS Col DC Tornado Red	Colour Code 504

Note: If vehicle has no cab rack fitted, proceed to Step 2.

- 1 Unbolt and remove the vehicles cab rack.
See **ILL 1-a**.
- 2 Trim to length a piece of **ANG100** and rivet it to the front panel in the normal manner.
- 3 Place canopy on it's front end on a soft surface and remove the base rail protector strips. See **ILL 1-a**.

Any forgotten screw leads to damage on the vehicle. Make sure that all screws are removed. **ILL 1-b**.

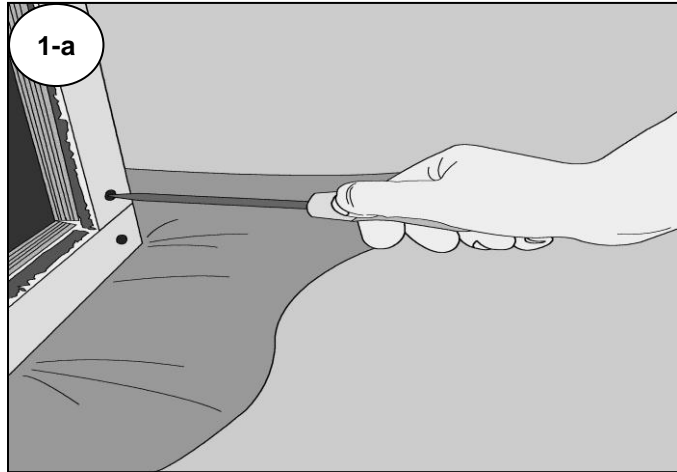

- 4 Lift prepared canopy onto tub and position just back from front on tub.
- 5 Remove the rubber trim from each canopy base side rail and retain for future use. See **ILL 2**.
- 6 If an over lip liner is fitted holes will need to be cut in the liner to allow the fitment of the six clamps. If an underlip liner is fitted ascertain how stiff the plastic is. If it is too stiff to allow the clamp to be pushed up between it and the metal lip, proceed as follows.



- 7 Position the clamps so as to miss any ribs on the liner and if possible missing the canopy, alloy rail securing screws. The front and rear clamps should be approximately 150mm from their respective rail ends. See **ILL 3**.

Note: If the securing screws cannot be avoided cut a notch in the clamp locating ridge of the top jaw of the clamp to bridge them. See **ILL 4**.

- 8 Use a 40mm hole saw to cut a hole in the liner so that the top is level with the bottom edge of the coaming lip. Repeat for all six holes.
- 9 Fit a clamp at each hole position as in **ILL 3**.
- 10 Use a 17mm socket and a torque wrench to pull down each clamp to a setting of **10NM**.

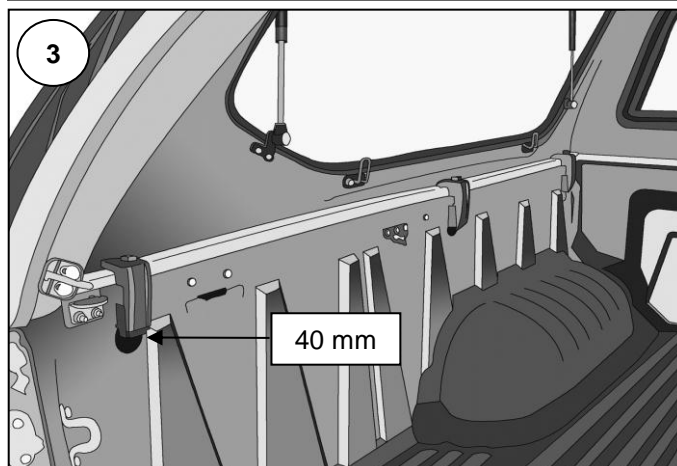
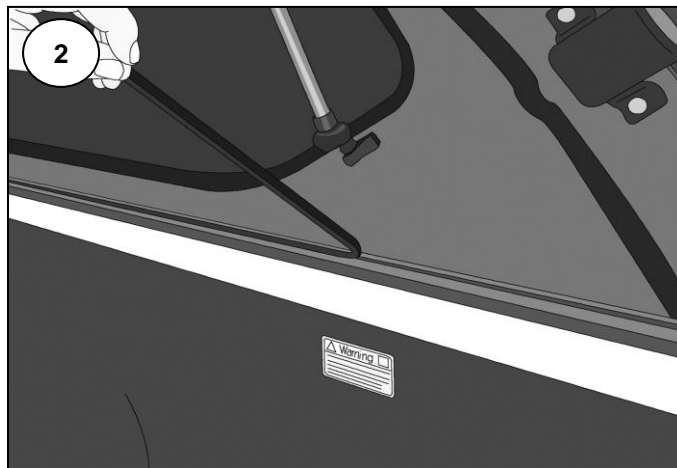

- 11 Carefully replace the rubber trim to the bottom rail channel. Cutting it either side of each clamp and each rail bolt as in **ILL 5**.

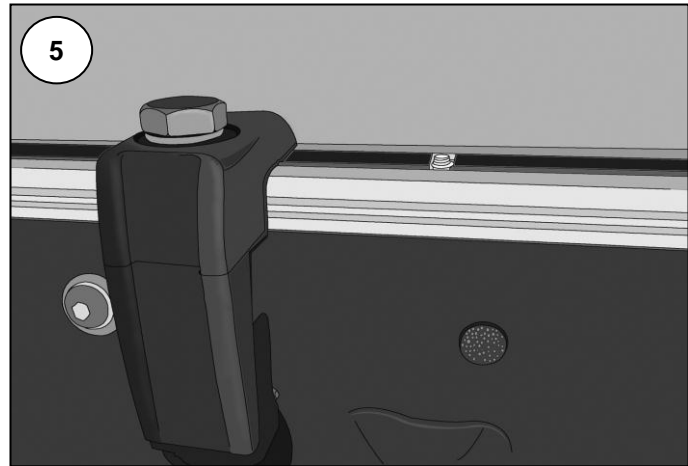
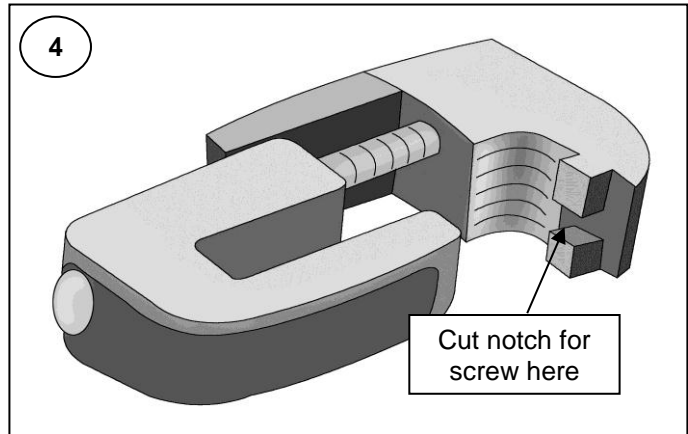

WIRING

ELECTRICAL WIRE STRIPPING SAFETY PROCEDURE

It is Flexiglass policy that the use of combination electrical cutting/crimping and stripping pliers be restricted to cutting and crimping use only.

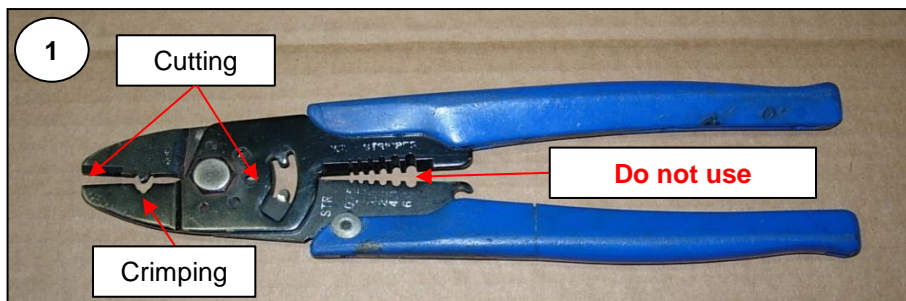

It is a documented fact that the use of these pliers can cause personal injury due to the fact that they are reliant upon holding the cable in one hand while pulling with the pliers with the opposite hand. Any attachments to the gripped end can be pulled into and through the palm of the gripping hand causing injury.

The single hand action strippers are to be used at all times for stripping cable ends ready for joining or connecting.

Two types of cable strippers are recommended, one operates with the pliers at 90° to the cable **(2)** the other operates in-line with the cable **(3)**.





The tool in **ILL 2** is a generally stronger and harder wearing item but the other is very useful for getting to cables in restricted space, it is therefore recommended that both types be available.

OPERATING INSTRUCTIONS

- 1 Squeeze handles sufficiently to bring the lever jaws together. Lay cable between stripping jaws as shown in **ILL 4**.

Note:

There should be no necessity to strip more than 10mm of sheathing from the cable end for any of the connectors used by Flexiglass. If for any reason a longer stripped end is required, do it in repeated 10mm bites, the pieces can then be slid off the end using the fingers.

- 2 Continue squeezing the handles together to engage the gripping and stripping jaws.

- 3 Increase the pressure slightly as you continue to squeeze. The stripping jaws will then move independantly of the pliers cutting and stripping the end of the wire until with a sharp click both sets of jaws will automatically disengage.

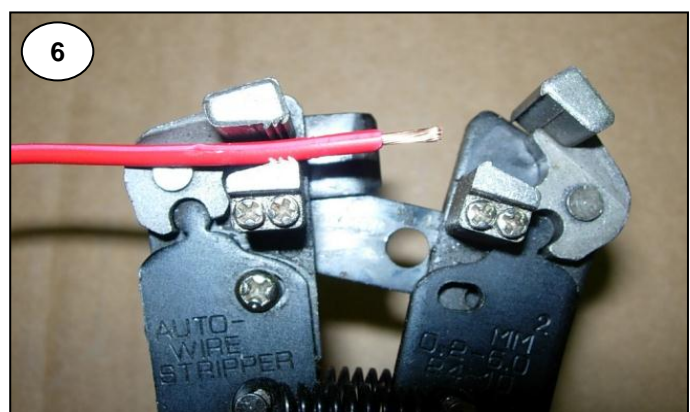
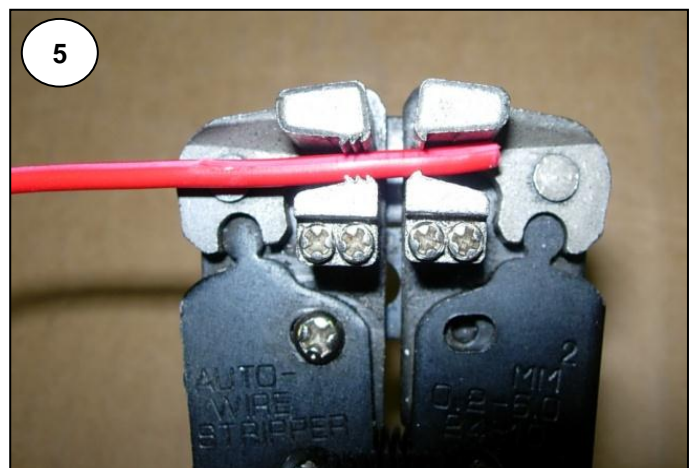
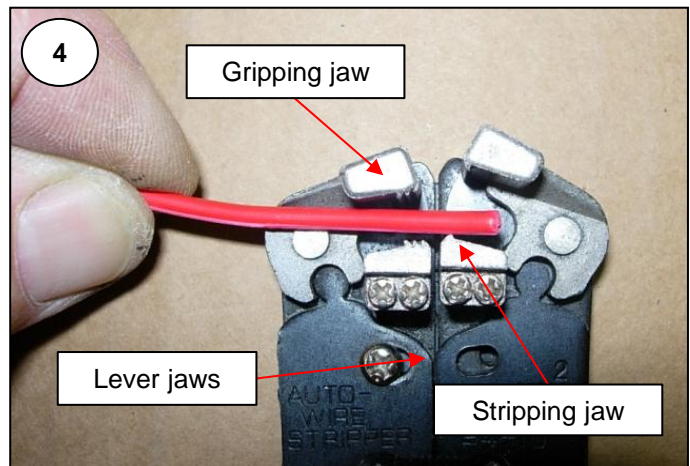

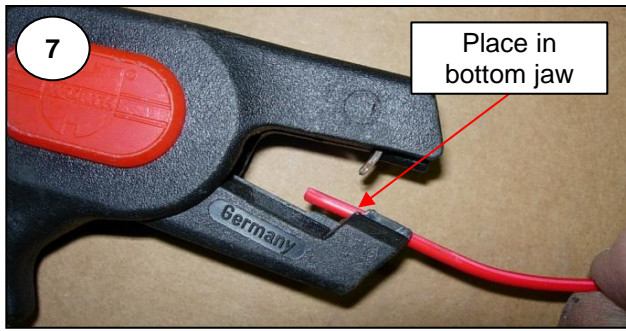

4 The Wurth pliers are simpler in operation. After placing the cable in the "V" of the bottom jaw, **ILL 7**, squeeze the handles together. The squeezing action brings the jaws together and forces the bottom jaw forward both cutting and pulling the sheath from the cable. See **ILL 8 & 9**.

12 At the drivers door and foot well, remove the scuff panel, kick panel, fuel cap release cover and the pinch weld around the bottom of the frame. See **ILL 6**.

13 Lift the carpet out of the way along the side of the seat and with a hole saw drill a 20mm hole through the floor, be very careful not to damage any of the adjacent wires or cables. See **ILL 7**.

14 From inside the vehicle pass the connector end of the harness through the hole and continue until there is only sufficient to run forward with the junction about level with the accelerator pedal.

15 Wind the blue Flexisport wire around existing wiring and bring it to the top of the brake pedal switch, tap it in to the red wire coming from the switch. See **ILL 8**.

16 Above the accelerator pedal behind the kick panel, connect the green Flexiglass wire to the black/red wire coming from the junction. See **ILL 9**.

17 Cut both wires on the Flexisport fuse holder to about 120mm long, attach a female bullet connector **CONF100** to one end only and remove the fuse until ready to test light function.

18 Tap the bare ended fuse wire (red) to the white/black wire shown in **ILL 10**.

19 Use a 10mm spanner and remove the screw indicated in **ILL 10** fit the demister relay and earth lead to the body using it in that position.

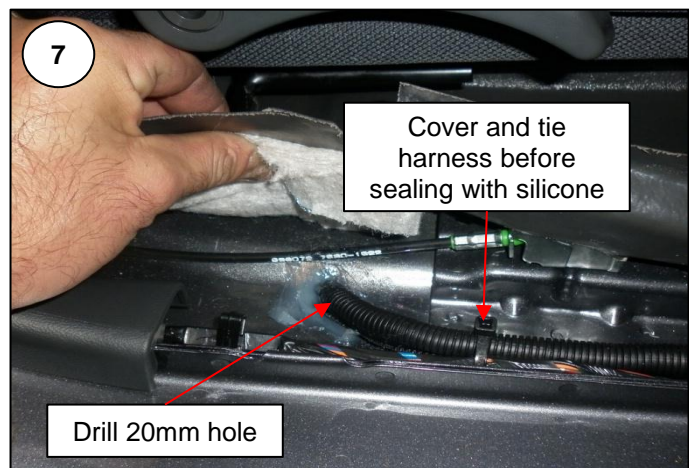
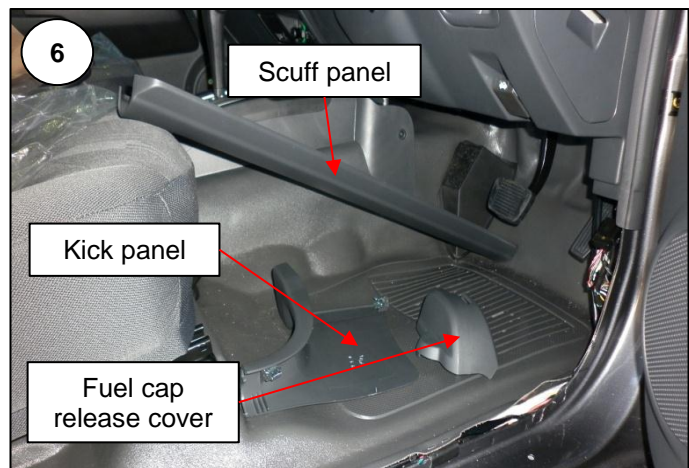

- 20 At the lower junction tap the yellow Flexisport wire into the blue/red vehicle wire and the grey Flexisport wire into the blue vehicle wire. See ILL 11.
- 21 Plug the two Flexisport harnesses together, refit the fuse in the holder and check the function of all the lights, locks etc.
- 22 If all functions are correct, tidy and tie all loose wires in the foot well area. Cover the harness running along the door sill to the hole in the floor with convoluted conduit pushing it through the hole a short way.
- 23 Tie the conduit to adjoining vehicle harness for stability and fill gaps with silicone sealant as in ILL 7.
- 24 Place a small patch of polythene wrapping film over the silicone to prevent the carpet getting glued to it and replace the carpet, scuff and kick panels and the fuel cap release lever cover.
- 25 Beneath the vehicle run the harness back from the hole in the floor, keeping it above the chassis or along it's side. Tie it at regular intervals to crossbars, brackets and existing wiring but not directly to brake lines.
- 26 At the rear of the cabin wrap the connectors in electrical insulation tape then gather the excess harness into a neat bundle and tie it out of sight where it cannot fall down or get damaged.
- 27 Tidy and detail the canopy ready for inspection and delivery to the client.

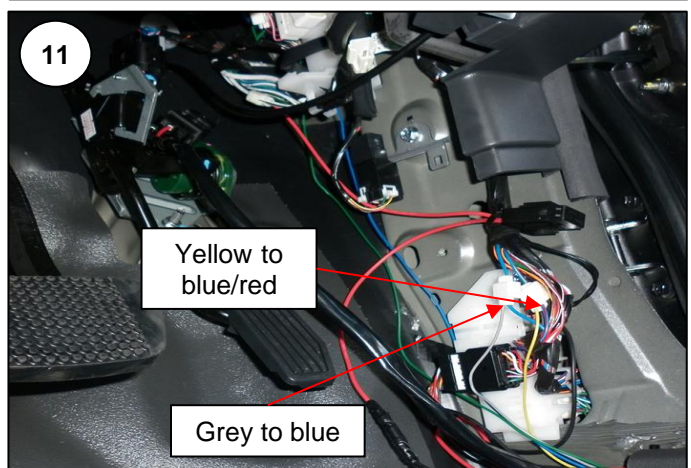
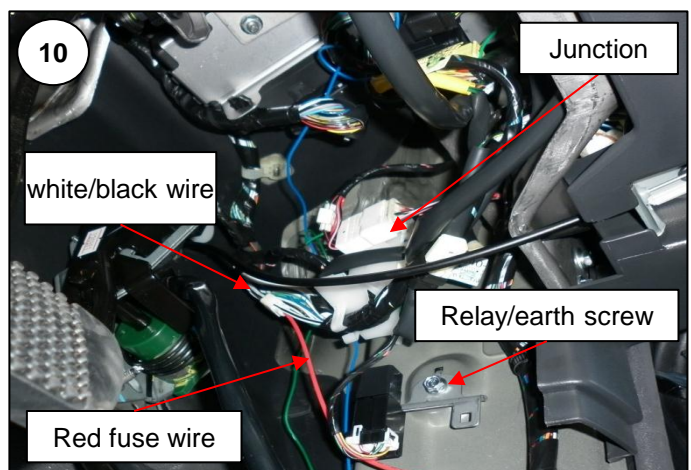
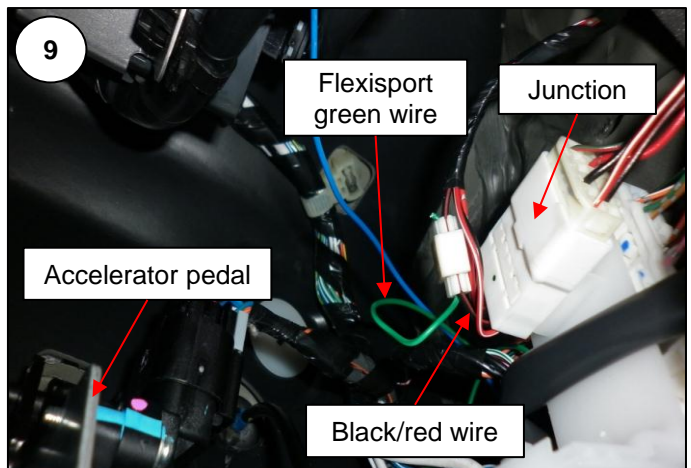
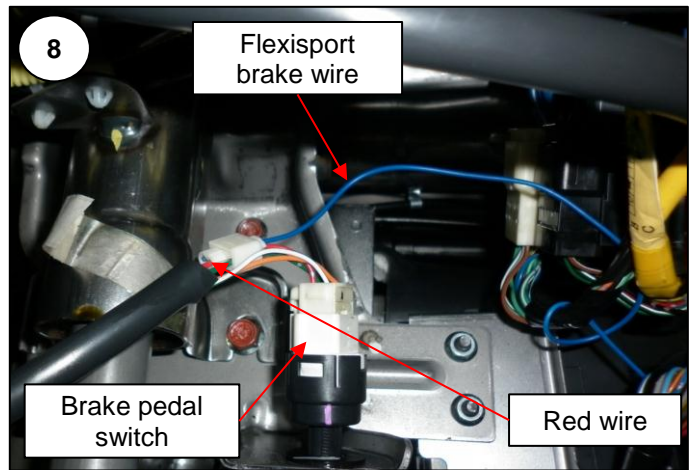

- 28** The canopy harness relay is not a waterproof relay.
We recommend to keep the relay behind the the kick panel **ILL 12**.
Never place the relay out of the car **ILL 13**.

