



## FLEXIGLASS FITTING MANUAL - SECTION 1.5D

### MITSUBISHI TRITON MQ/MR

### FLEXISPORT / FLEXISPORT PREMIUM CANOPY FIT - ISSA2

**Note:** Familiarise yourself with the instructions before you start to ensure you are clear on all aspects of the fit

#### SAFETY EQUIPMENT

- Hearing protection as required
- Eye protection as required

#### TOOLS REQUIRED

- Plywood or cardboard sheet
- Pneumatic or hand hacksaw
- Grinder, sander or file
- Metal priming paint
- Paint brush
- Silicone sealant & applicator
- Pneumatic or electric drill
- 5mm Drill bit
- Rivet gun with 5mm capacity
- 6mm Allen key
- Pneumatic or hand driver
- 17mm Socket
- 25NM torque wrench
- Cable cutter, stripper, crimp tool
- Lock tight
- Knife or scissors
- Snake for guiding cables
- IPA Wipes or similar cleaning product

#### MATERIALS & PARTS REQUIRED (FIT KIT 215)

Part No.	Description	Qty.
GRO10	Grommet Champ 3/16x5/16x7/16	1
TAPE180	Tape 4203 Front Tube 25X3 25M	
FUSE300	NARVA Add Circuit Fuse Holder	1

**Note:** If vehicle has no cab rack fitted, proceed to Step 4

- 1 Place a piece of thin plywood or heavy duty cardboard sheet between the cab and the tub to protect paint and glass whilst cutting the cab rack off.
- 2 Sand cut areas of front panel flat and paint bare metal with metal priming paint.
- 3 Remove protective sheet from the vehicle.
- 4 Place canopy on it's front end on a soft surface and remove the base rail protector strips. See **ILL 1**. Any forgotten screw leads to damage on the vehicle. Make sure that all screws are removed. **ILL 1-b**.
- 5 Apply a strip of truck tape **TAPE180** across the top of the tub front panel.
- 6 Lift prepared canopy onto tub and feed wiring harness down between the cab and tub.

7 Remove the rubber trim from each canopy base side rail and retain for future use. See ILL 2.

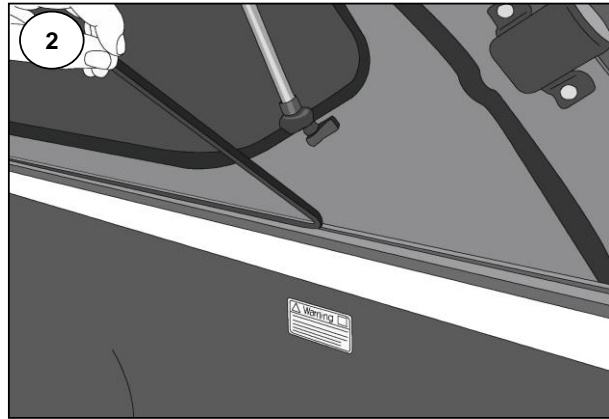
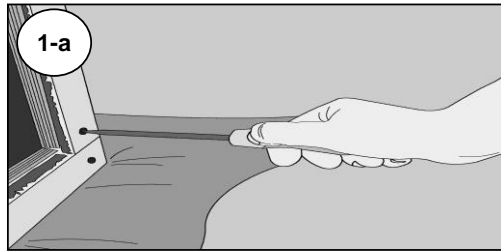

8 If an over lip liner is fitted, holes will need to be cut in the liner to allow the fitment of the six clamps. If an underlip liner is fitted ascertain how stiff the plastic is. If it is too stiff to allow the clamp to be pushed up between it and the metal lip, proceed as follows.

9 Position the clamps so as to miss any ribs on the liner and if possible missing the canopy alloy rail securing screws. The front and rear clamps should be approximately 150mm from their respective rail ends.  
**Note:** If the securing screws cannot be avoided cut a notch in the clamp locating ridge of the top jaw of the clamp to bridge them. See ILL 3.

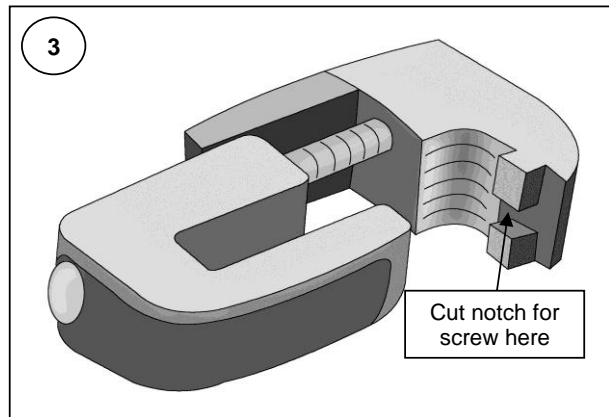

10 Use a 40mm hole saw to cut a hole in the liner so that the top is level with the bottom edge of the coaming lip. Repeat for all six holes.

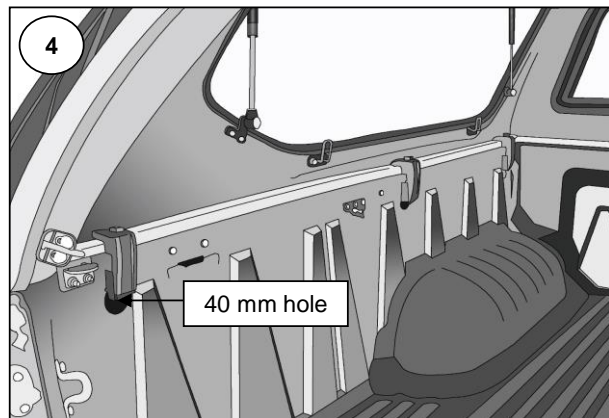

11 Fit a clamp at each hole position. See ILL 4.

12 Use a 17mm socket and a torque wrench to pull down each clamp bolt to **10NM**.

13 Carefully replace the plastic trim to the bottom rail channel. Cutting it either side of each clamp and each rail screw as in ILL 5.



- 14 Working on the passenger side of the vehicle remove the scuff cover from the front door sill. Then remove the side kick plate in the passenger foot well. See **ILL 6** and **note 15** below.

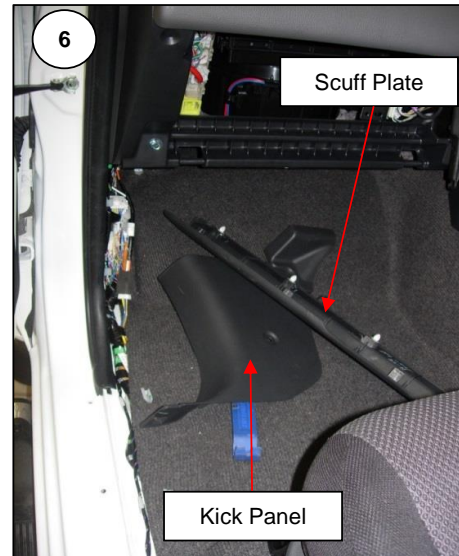

**NOTE:**

- 15 Ensure the plastic screw-plug is removed before pulling the kick panel out. **ILL 6A**

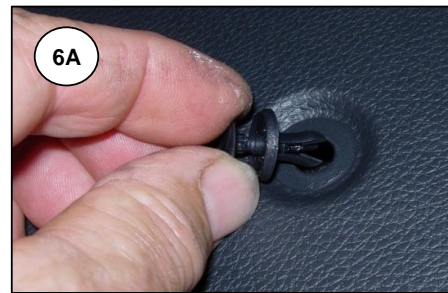

- 16 Remove the glove box by opening it first then lifting until the hinges pop off. Rotate the box to the rear to clear the stop lugs then disconnect one end of the small gas strut, lift the box out of the way. **ILL 7**.

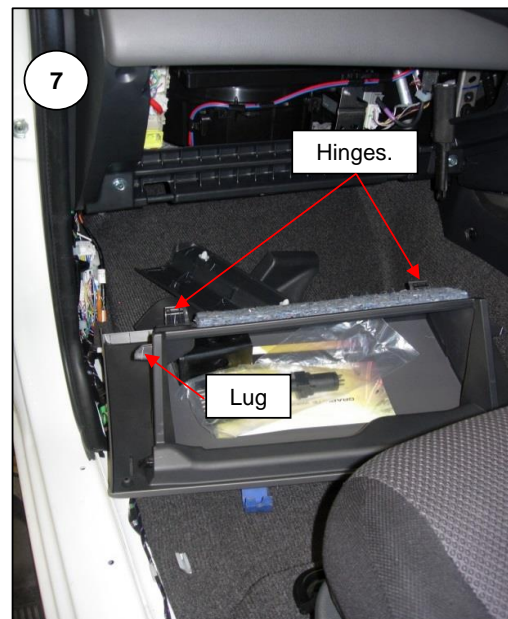

17 Lift the carpet beside the seat and cut a 19mm hole through the floor of the vehicle, as shown in **ILL 8**.

18 Pass the canopy wiring harness through a 19mm grommet then from inside the car pass the harness down through the floor and fit the grommet into the hole.

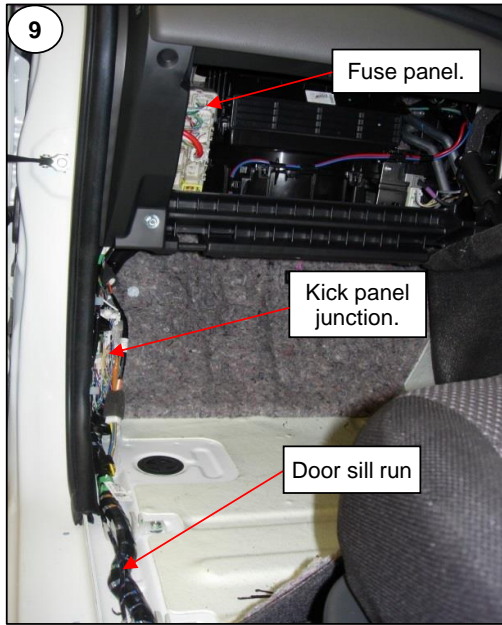
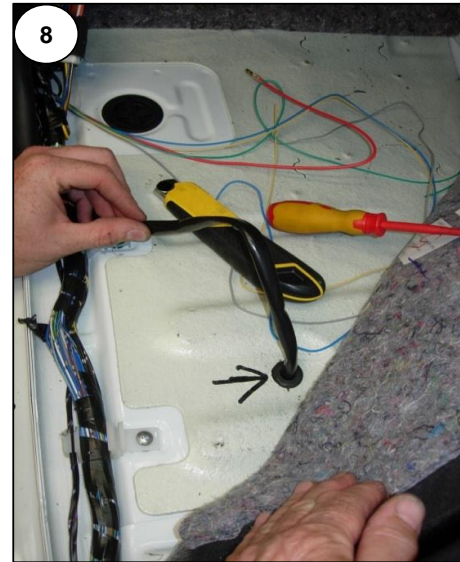

19 At the fuse panel a vacant power circuit is available at the top of the second row of fuses from the left. Insert a 20A mini fuse in the top position of the **FUSE300** connector and fit it in position as shown in **ILL 10**.

20 Discard the entire canopy fuse extension assembly, cut the male bullet connector from the end of the de-mist power cable and strip the end of the casing. Attach the exposed end to the **FUSE300** "piggy back" fuse, with the crimp connector supplied on the cable end.

21 Connect the earth line to the securing bolt as shown. **ILL 10**.

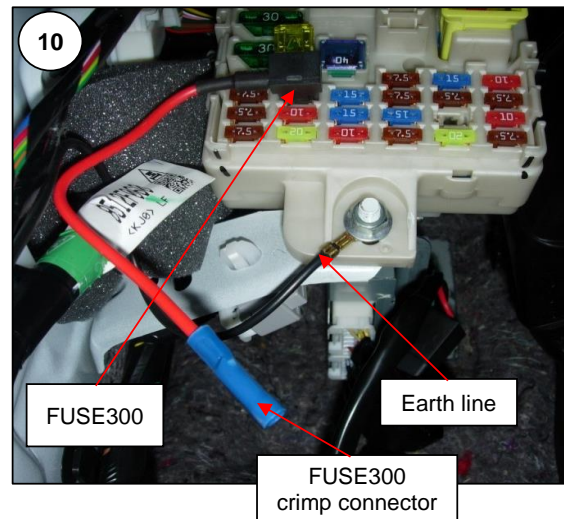

### WIRING INSTRUCTIONS

- For brake and demister cable of the MR Triton, see the MR Triton Section (Step 26)

22 At the kick panel junction, locate the blue/red cable with two silver bands and the blue/black with two silver bands. Connect the canopy grey to the blue/red and the yellow to the blue/black. **ILL 11.**

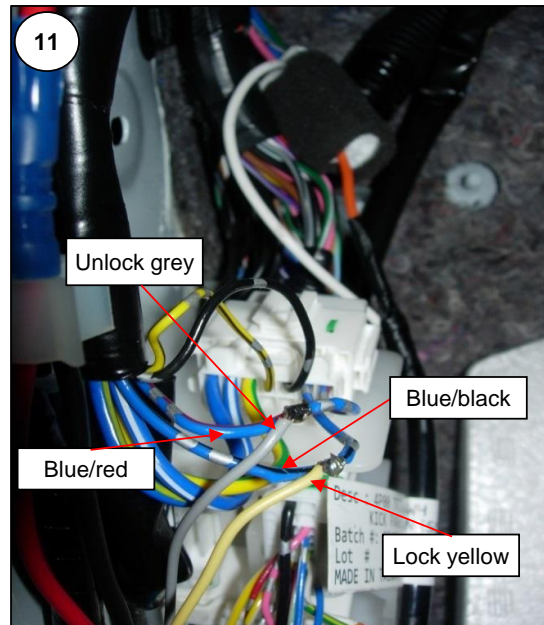

23 The door sill run is composed of two separate bundles of cables, both will require unwrapping to carry out the required connections. **See ILL 12.**

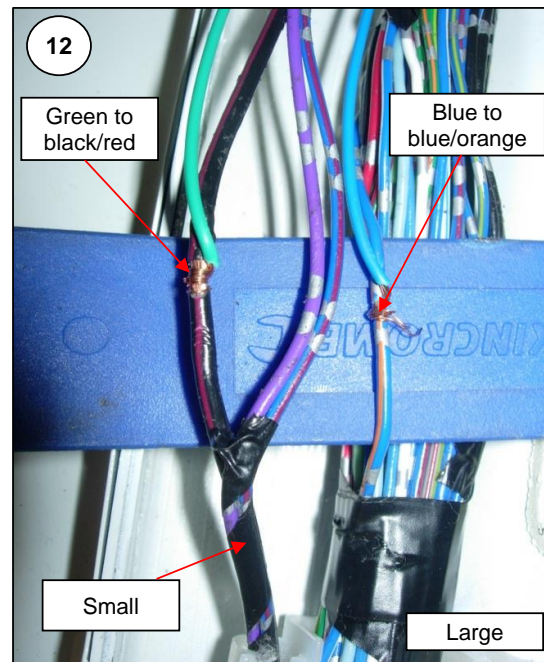

24 Locate the black/red vehicle cable in the small bundle and tap the green demist switch cable to it.

25 Locate the blue/orange vehicle cable in the large bundle and tap the blue brake cable to it. **ILL 12.**

#### MR Triton Section (Brake & Demister Cable)

26 Only difference between MQ and MR Triton is the appearance of the cable bundles. The door sill run is composed of two separate bundles of cables, both will require unwrapping to carry out the required connections. **ILL 13.**

27 Despite the change in appearance, the colour of the wires remain the same.

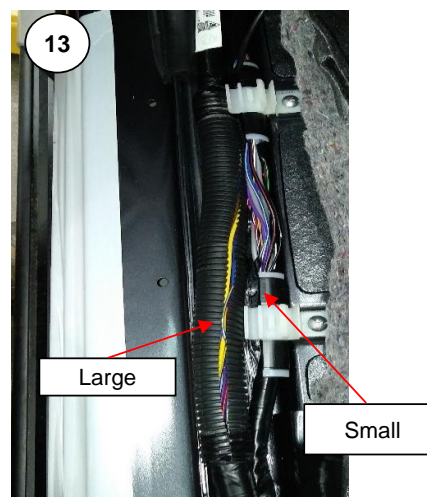

- 28** There are two black/red wires; one of them thick and the other one is thin. Use the thick cable. Locate the **thick** black/red vehicle cable in the small bundle and tap the green demist switch cable to it. **See ILL 14.**

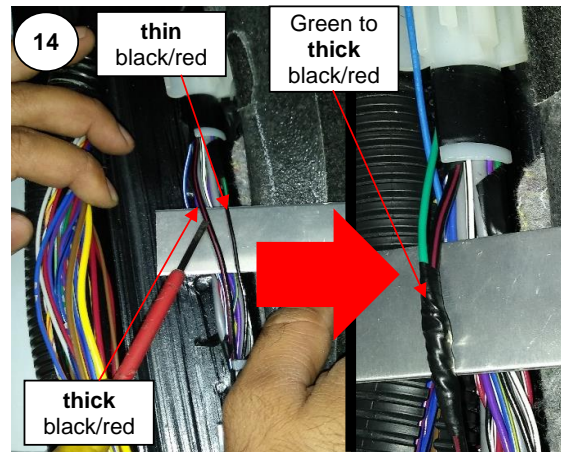

- 29** Locate the blue/orange vehicle cable in the large bundle and tap the blue brake cable to it. **ILL 15.**

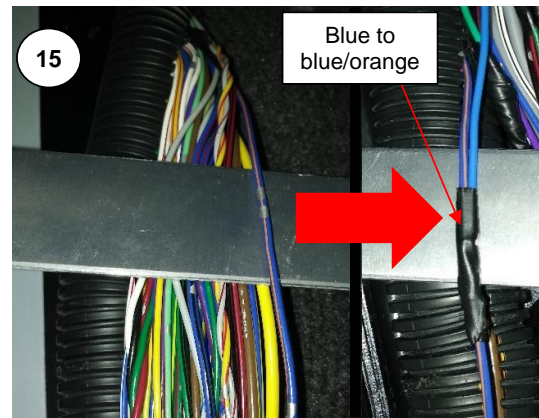

- 30** Run the outer end of the FlexiSport harness back to the connectors of the canopy wiring harness. Snap all connectors together and replace the fuse in its holder.
- 31** The canopy harness relay is not a waterproof relay. We recommend to keep the relay behind the the kick panel **ILL 16.**

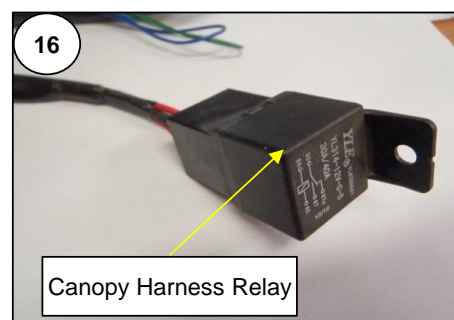

**32** Never place the relay out of the car **ILL 17**.  
Check function of all circuits and rectify any malfunctions.

**33** Once all is correct tie and tidy all loose cables etc in the drivers compartment.

**34** Under the vehicle tie the harness to existing wiring or brackets to prevent it dropping down or rubbing.

**35** With the harness secure, seal the exit hole with silicon sealant and cover with a patch of plastic packaging film to prevent the carpet sticking, then replace all trim panels.

**36** Wrap the canopy wiring connectors with insulating tape, bundle the harness up and secure it out of sight under the vehicle away from heat (exhaust) and damage from flying debris.

**37** Clean and detail canopy and vehicle ready for inspection and delivery to the client.

